



Features

- True double-conversion
- DSP technology guarantees high reliability
- N+X parallel redundancy
- Selectable quantity of battery for each group:16/18/20 pieces
- 3-stage charging design optimizes battery performance
- ECO mode operation for energy saving
- Self-diagnosis at startup
- Emergency power off function (EPO)
- Maintenance bypass (Optional) is convenient for maintenance
- Generator compatible
- Communications:RS-232,USB,SNMP card (Optional), Relay card (Optional)
- Cold start



Battery Cabinets.
(Optional)



Control Panel

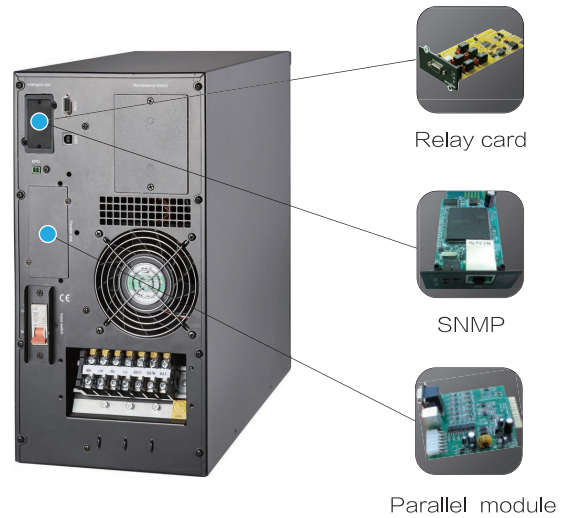

Rear Panel

Technical Specifications

MODEL	UB60	UB60L	UB100	UB100L
Capacity (VA/Watts)	6K / 5.4K		10K / 9K	
INPUT				
Nominal Voltage	220/230/240Vac(L+N+PE)			
Operating Voltage Range	120-276Vac			
Operating Frequency Range	50Hz: 45-55Hz, 60Hz: 54-66Hz			
Power Factor	≥0.99			
Bypass Voltage Range	Max.voltage: 220V: +25%(Optional +10%,+15%,+20%)			
	230V: +20%(Optional +10%,+15%)			
	240V: +15%(Optional +10%)			
	Min. voltage: -45% (Optional -20%,-30%)			
ECO Range	Same as bypass			
Harmonic Distortion (THDi)	≤5%(100% non-linear load)			
OUTPUT				
Output Voltage	220/230/240Vac			
Power Factor	0.9			
Voltage Regulation	±1%			
Frequency	Line Mode	±1%/ ±2%/ ±4%/ ±5%/ ±10% of the rated frequency(Optional)		
	Bat. Mode	(50/60 ± 0.1)Hz		
Crest Factor	3:1			
Harmonic Distortion (THDv)	≤2% with linear load			
	≤5% with non-linear load			
Waveform	Pure Sinewave			
Transfer Time	Utility to Battery : 0ms; Utility to Bypass: 0ms			
EFFICIENCY				
Efficiency	Up to 94%			
BATTERY				
Battery Voltage	Selectable Voltage: ± 96/108/120Vdc			
Typical Recharge Time	6-8 hours (To 90% capacity)			
Charging Current	Maximum current 10A			
PROTECTION				
Overload	Line Mode	Load≤125%: last 5min; ≤150%: last 1min; > 150% 200ms turn to bypass mode		
	Bypass Mode	40A(Input breaker)		60A(Input breaker)
Short Circuit	Hold Whole System			
Overheat	Line Mode: Switch to Bypass; Backup Mode: Shut down UPS immediately			
Battery Low	Alarm and Switch off			
INDICATORS				
Audible & Visual Alarms	Line Failure, Battery Low, Overload, System Fault			
Status LED & LCD Display	Line Mode, Backup Mode, Eco Mode, Bypass Mode, Battery Low, Battery Bad, Overload & UPS Fault			
Parameters On The LCD Panel	Input/Output Voltage, Input/Output Frequency, Load Level, Battery Level, Inner Temperature & Remaining Battery Backup Time			
MANAGEMENT				
Communication Interface	RS-232,USB,Parallel card(Optional), SNMP card(Optional), Relay card (Optional)			
ENVIRONMENT				
Operating Temperature	0 ~ 40°C			
Storage Temperature	-25 ~ 55°C			
Humidity Range	0 ~ 95% (Non-condensing)			
Altitude	< 1500m			
Noise Level	<55dB			
PHYSICAL				
Dimension W × D × H (mm)	250 × 502 × 616	220 × 481 × 438	250 × 502 × 616	220 × 481 × 438
Net Weight (kg)	62	18	64	20
STANDARDS				
Noise Suppression	Complies with EN62040-2			
Safety	IEC/EN62040-1,IEC/EN60950-1			
EMC	IEC/EN62040-2,IEC61000-4-2,IEC61000-4-3,IEC61000-4-4, IEC61000-4-5,IEC61000-4-6,IEC61000-4-8			
BATTERY PACK				
Model	EXB ± 120V			
Battery type& Max.quantity	7Ah × 40/9Ah × 40			
Dimensions W × D × H (mm)	250 × 502 × 616			
Net Weight (kg)	125.6/138			

Specifications are subject to change without prior notice.